

Haenim UV Bottle Sterilizer

Haenim New Classic Instruction

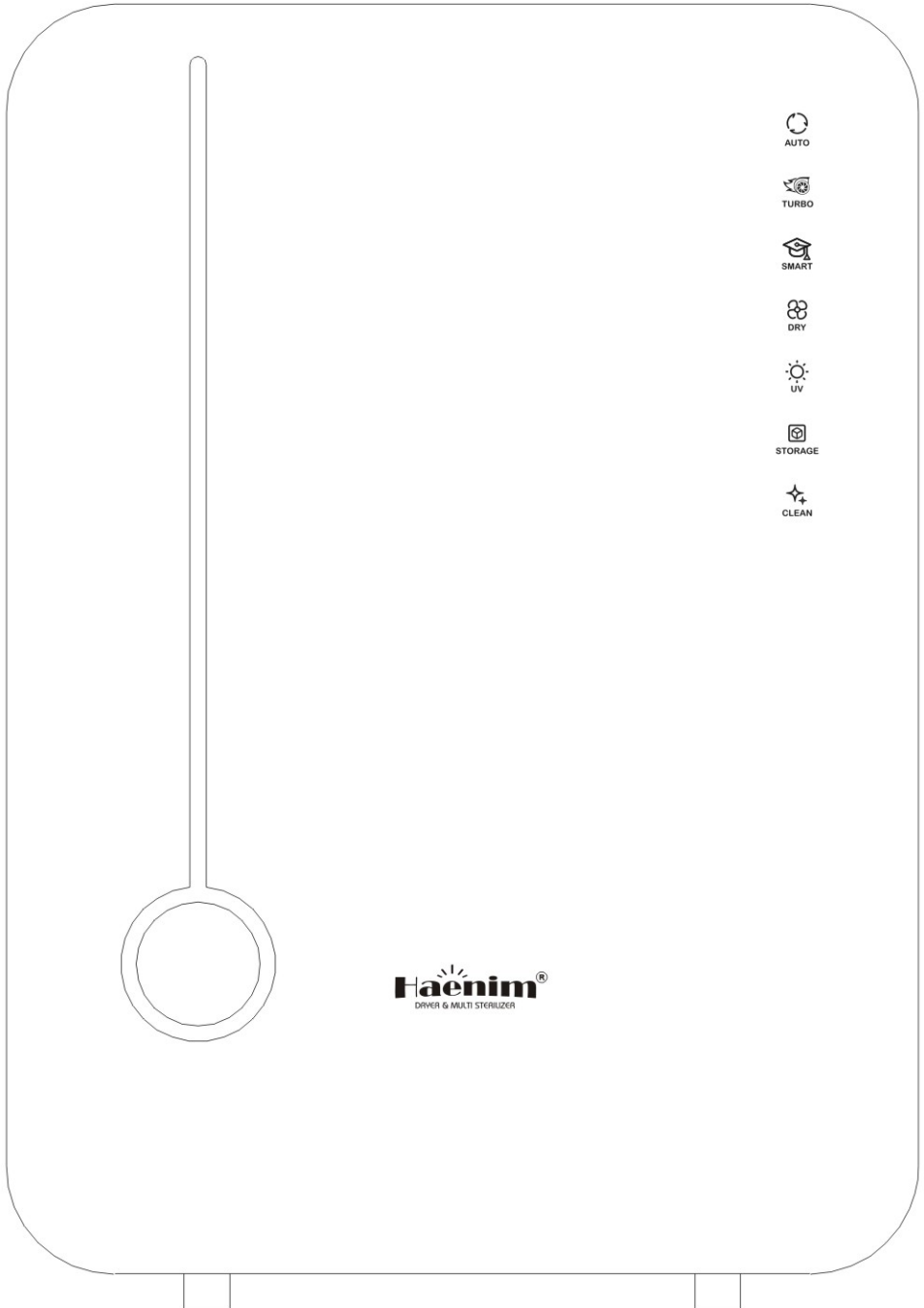

AUTO

TURBO

SMART

DRY

UV

STORAGE

CLEAN

Haenim[®]
DRYER & MULTI STERILIZER

? Items to confirm before using

Accessories

○ Upper Shelf ○ Bottom Shelf ○ Water Tray ○ Power cord

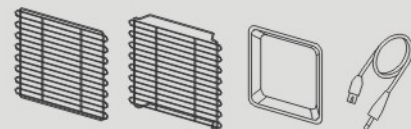

Haenim Specifications

Type	Free standing type
Dimensions	295(W)×375(D)×425(H) mm
Rated Voltage / Frequency	AC 220V / 50Hz or 60Hz
Rated power consumption	70W (Turbo 120W)
Drying / sterilization method	Built-in PTC heater / UV lamp
Product weight	5Kg (net)

Utilization of the shelf

As shown in the figure, place the upper Shelf at the top left and the top right 4 protrusions at 13cm over the stainless steel bottom and place the water tray on the bottom and then the bottom Shelf on the water tray and use them. For sterilization, it is recommended to use after placing the bottle inlet facing the upper lamp as shown in the figure.

(There is a difference in sterilization power.)

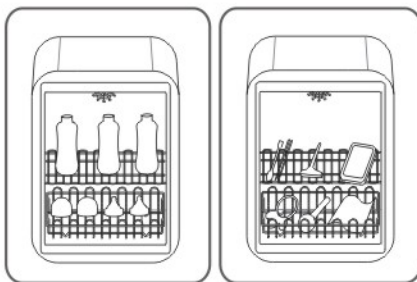

Name of each part

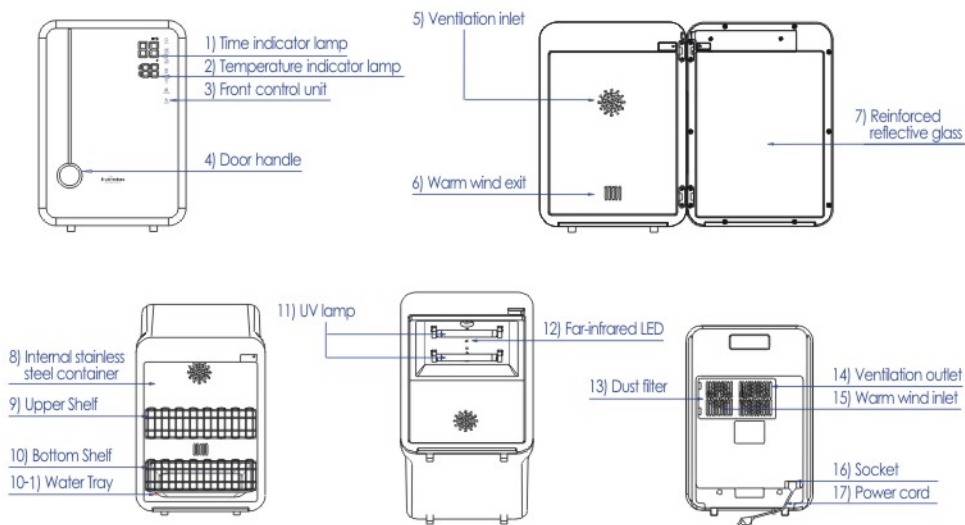

AUTO mode



1

Drying (20 minutes)
Sterilization (5 minutes)
Ventilation-Simultaneous operation (30 minutes)

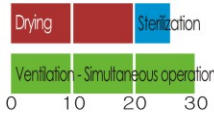

2

Drying (40 minutes)
Sterilization (5 minutes)
Ventilation - Simultaneous operation (50 minutes)



3

Drying (60 minutes)
Sterilization (5 minutes)
Ventilation - Simultaneous operation (70 minutes)



TURBO mode



1

Drying (10 minutes)
Sterilization (5 minutes)
Ventilation-Simultaneous operation (20 minutes)



2

Drying (35 minutes)
Sterilization (5 minutes)
Ventilation-Simultaneous operation (40 minutes)

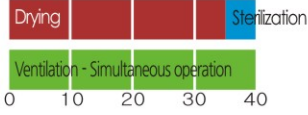

3

Drying (55 minutes)
Sterilization (5 minutes)
Ventilation-Simultaneous operation (60 minutes)





SMART mode

SMART mode is the sterilization storage function including the drying.
(*cannot be applied together with Storage function.)



1. Tap to make the selection Smart mode,
Automatically activates 20minutes DRY, 5minutes UV every 3hours for total of 8 cycles
2. Opening and then closing the door activates Sterilization 1 minute automatically

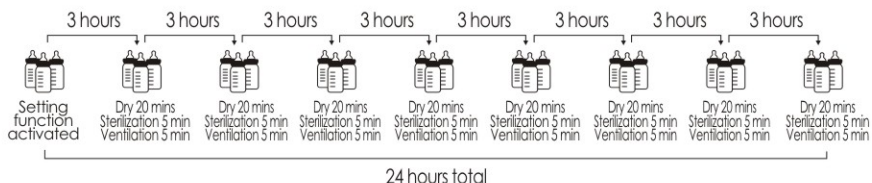

DRY mode



Drying (10 minutes)
Ventilation-Simultaneous operation (10 minutes)



Drying (20 minutes)
Ventilation-Simultaneous operation (20 minutes)



Drying (40 minutes)
Ventilation-Simultaneous operation (40 minutes)

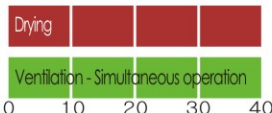



STERILIZATION mode



Sterilization (5 minutes)

Ventilation - Simultaneous operation (5 minutes)
0 5



Sterilization (10 minutes)

Ventilation - Simultaneous operation (10 minutes)
0 10

Know the function of sterilization!

- When sterilizing using ultraviolet rays, there may be a unique smell of disinfection. The smell distinctive to the sterilization is a unique disinfection odor that occurs when ultraviolet rays destroy oxygen in the air. So, you may reassure yourself in using it.
- UV disinfection may cause discoloration into yellow of the bottle and the nipple. Test results show that it is natural, so it cannot be any problem.



STORAGE

STORAGE mode

Tap to make the selection Storage mode, Automatically activates 1 minute UV every 2 hours for total of 4 cycles.

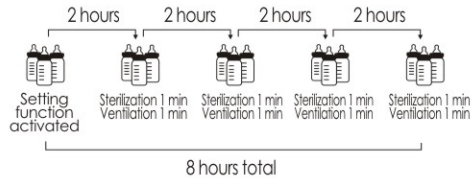

CLEAN

CELAN mode

After more than 60 hours of use, the clean button alarm is activated. After cleaning the inside, press the CLEAN button to automatically reset.



Safety Precautions



Prohibited - Potential hazards that could result in damage to the product or a mild injury if not avoided

1. Please use only within the country; (220v 60Hz exclusive product.)
2. Please do not bask directly in the light after you open the door of this product and forcibly switch on the built-in sterilization lamp.
3. Do not disassemble or modify the product at will when the product is flooded, cleaned, or moved and installed.
4. Do not cage an animal in the product or put any vinyl weak in heat, thinner, benzene etc. in the product.
5. Do not forcibly remove the power plug while the product is up and running.
6. Install the product away from a direct sunlight on a flat surface.
7. Do not use chlorine disinfectant (chlorine bleach) inside the product as it causes corrosion to stainless steel.
8. Ensure that the filter at the rear of the product has a certain space so that air can be taken in and exhausted.
9. We recommend to clean the filter with water once a month.
10. If too many bottles, dishes, and cups are stored, the sterilizing effect is reduced.
11. The internal stainless steel container may catch scale, so please clean it once a month.



Warning - Potential hazards that could result in a death or a serious injury if not avoided

1. If the product smells burning, please immediately unplug the power cord and contact the customer center.
2. Do not plug or unplug the power cord with wet hands.
3. Please install it out of the reach of children. (It may cause a falling.)
4. Do not bend, tie or pull the power cord excessively.
5. Be sure to unplug the power cord when it is thundering or lightening, or you clean or repair.
6. Remove any foreign matter from the power plug with a dry cloth.
7. Do not use in damp places such as bathrooms, shower booths, swimming pools, etc.
8. If there is a leakage or a suspected leakage of city gas, stop operation of the product and ventilate it.



Self-diagnosis & lamp replacement

Self-diagnosis

Please check the following before requesting self-diagnosis service.

In case the sterilization lamp does not turn on

- Ensure that the power cord is inserted into the wall and the product receptacle.
- Make sure that the sterilization lamp is operated after drying is completed and that the sterilization button is pressed.
- Please check whether the sterilization lamp has been used for a long period of time exceeding the replacement time.

In case the drying lamp does not turn on

- Ensure that the power cord is inserted securely into the wall outlet or the product socket.
- When the sterilization button is pressed, the dry lamp will not turn on.

In case it cannot dry out

- Is the room temperature too low or is it located by the window to be affected by the outside air?
(If the room temperature is too low, the drying capacity may drop.)
- For a perfect drying it is necessary to shake water 3 to 5 times off the contents to dry so that water droplets may not accumulate.
- In case there are much content to dry, operate it while pressing AUTO button thrice.

Lamp replacement

Warning : When replacing the lamp, be sure to remove the power plug first.

- How to replace the lamp -

Hold both ends of the lamp with your fingers and turn it about a half turn to disassemble it through the opening in the socket as shown and replace it with a new lamp. (This is the same as replacing a fluorescent lamp in common households.)
(Please insert in the reverse order of disassembly.)

- Disposal of Waste Products -

Disposal of plastic products should not be discarded or incinerated at will. Please contact the waste related agency or local government office.

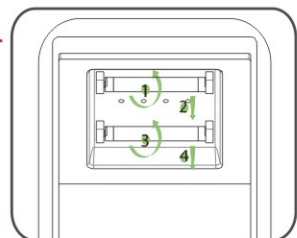



Free and paid warranty



In accordance with the Consumer Dispute Resolution Standards (Fair Trade Commission Notice 2009-1) by item, we guarantee the product as follows.

Electric sterilizer (for home use) warranty period: 1 year, parts retention period: 6 years

*** The warranty period is reduced to half when the general product is switched to business use. (Business, accommodation, public place, etc.)**

*** The warranty period is calculated from the date of purchase. If the date of purchase cannot be confirmed, the warranty period will be calculated from the date three months have elapsed from the date of manufacture.**

Consumer dispute resolution standards

Types of Consumer's Damages	within Warranty Period	after Warranty Period
When major repair is required within 10 days of purchase	Product exchange or purchase price refund	Not applicable
When major repair is required within one month of purchase	Product exchange or free repair	Not applicable
Damages that have occurred during shipping process or product installation after purchasing the product	Product Exchange	Not applicable
When exchanged product fails within one month, which requires major repair.	Purchase price refund	Not applicable
If not exchangeable	Purchase price refund	Not applicable
When the same fault occurs up to two times	Free repair	Paid repair
When the same fault has occurred three times	Product exchange or purchase price refund	Paid repair
When 5 faults of different nature have occurred	Product exchange or purchase price refund	Paid repair
When repair is not possible due to parts for repair not available within the part retention period	Product exchange or purchase price refund	Refund by adding 10% to the flat depreciation amount
When repair is not possible though parts for repair are available	Product exchange or purchase price refund	Refund after flat-rate depreciation

Paid service

In case it has been caused by consumer negligence

1. In case a failure has occurred due to careless handling or wrong repair by the consumer
2. In case a fault has occurred due to incorrect use of electric capacity
3. In case a failure or damage has been caused by external impact or dropping
4. In case a failure has occurred due to use of consumables and optional parts not provided by us
5. In case a failure has occurred due to not following the "Precautions" in the user manual

In other cases

1. Failure due to natural disasters (lightning, fire, salt damage, flood, etc.)
2. In case the consumables have reached the end of their life (consumables to be purchased separately)

*** As a request for a service with no failure found is to be charged, please refer to the user manual before requesting a service.**

*** This warranty document is to be applied in the Republic of Korea only and not to be re-issued. Therefore, please keep it safely with the user manual.**

Product Warranty

Product Name Haenim Baby Bottle Sterilizer New Classic (4G)

Model HN-04 and others

KC certification number

Serial number of manufacture

Date of purchase

Place of purchase

Name

Phone number

Address

Service cause

Manufacturer Haenim Co., Ltd.
15 21-beon-gil, Saryeom-ro, Seo-gu, Incheon
www.hnbaby.co.kr

The appearance and specifications of the product are subject to change for its improvement without a prior notice.

The color of the product shown may differ from that of the actual product due to the printing process.

The schedule for new product release is subject to change as it may chance.

In the case of sister models, their function may different from that of the product model explained. It is prohibited to reprint or copy without permission.

If you illegally use any pictures in this manual, you will have to bear civil and criminal liability under the copyright law.